

**OREGON PUBLIC LAND CORNER REPORT / RESTORATION REPORT**  
Tillamook County Surveyor's Office

**BOOK 8 208**

|   |                          |  |
|---|--------------------------|--|
| <b>SECTION:</b> 27 & 28   | <b>TOWNSHIP:</b> 1 South | <b>RANGE:</b> 10 West                          |
| <b>COUNTY:</b> Tillamook  |                          | <b>DATE:</b> 10/30/2024                        |
| <b>CORNER DESIGNATION:</b><br>The North Sixteenth corner common to sections 27 and 28, Township 1 South, Range 10 West; Willamette Meridian |                          | <b>(Please check one)</b>                      |
|   |                          | <input type="checkbox"/> Condition Report Only |
|   |                          | <input type="checkbox"/> Restoration           |
|   |                          | <input checked="" type="checkbox"/> Rewitness  |
|   |                          | <input type="checkbox"/> Unrecorded            |
|   |                          | <input type="checkbox"/> Reset at surface      |
|   |                          | <input type="checkbox"/> Referenced Out        |

**Previous Rewitnesses, Restorations and Surveys, etc...** B-1302 (1988), Rewitness book 6, page 349 (1988)

**History, condition, and sources:**

April 13, 1988, Gregory Crites Oregon Land Surveyor No. 1887, set a 3/4" by 36" iron pipe with a 3" brass cap stamped "CAVENHAM FOREST IND N 1/16 S28 S27 1988 T1S R10W WM LS 1887" and added accessories. In 2024 the Tillamook County Survey office found a 3" brass cap stamped as shown hereon in good condition. Record accessories are listed below.

Found: (rewitness book 6, page 349, 1988) windfall stump south 1.5'

Found: (rewitness book 6, page 349, 1988) 16" hemlock S8°W 13.13' to nail bottom face of scribe "N1/16S28BT" with yellow metal bearing Tree tag. Now a 41" diameter found bearing tree tag on the hemlock is not visible from the monument, so a new one was affixed to The tree on the monument side.

Found: (rewitness book 6, page 349, 1988) 6' white fiberglass fence post southwest 0.62'

**New accessories set:**

The Monument was tied conventionally using double occupied GPS control. Coordinates given hereon are provided in WGS 84 Latitude and Longitude.

Latitude: 45°27'35.74367"

Longitude: -123°54'23.93136"

Yellow Metal location tag affixed to the record bearing tree.

84" hat section post with yellow metal location tag was set North 2.0'

**Pictures of Found Monuments:**



**Location:** ±57' Easterly from the east edge of logging road 704

**Tillamook County Surveyor office:** 1510 3<sup>rd</sup> Street Suite C, Tillamook, OR. 97141

**Party Chief:** Travis Porter, Tillamook County Survey Office

**Witnesses:** Michael Rice P.L.S. 86926, Tillamook County Surveyor  
Kael Poklikuha, Tillamook County Survey Tech

**Notes:** Digital images taken of monument and accessories.

**SURVEYOR'S SEAL**

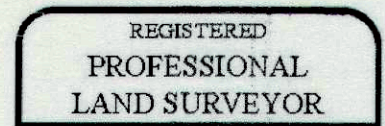

*Michael R. Rice*

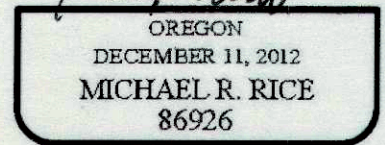

RENEWAL 12-31-2024

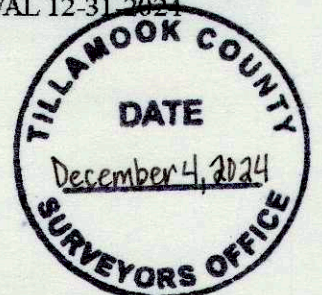

**BOOK 8 208**